



7171 Airport Road, Bath, PA 18014 Phone: 610-837-4100 Fax: 610-837-4105 www.graceind.net

March 8, 2024

Lehigh Township
1069 Municipal Rd
Walnutport PA 18088

RE: ECMS 12318 – SR 4020, Maple Road over Bertsch Creek, Lehigh Township

To whom it may concern:

Grace Industries will commence work the week of April 2nd, 2024, on the above reference project. This project consists of the replacement of the existing bridge carrying SR 4020 (Maple Rd) over Bertsch Creek and other miscellaneous construction.

Beginning April 2nd, 2024, through June 2024, expect construction traffic conditions.

The Roadway will be closed to traffic during construction and a Detour Route will be posted. I have attached a Detour Map for your reference.

If you have any further questions or concerns, please contact our office at 610-837-4100.

Sincerely,

Grace Industries, Inc.

CC: File
PennDOT District Community Relations Coordinator
PennDOT Special Hauling Permits
PennDOT Traffic Operations Center
Northampton County Maintenance
Northampton County 911
Lehigh Township
Lehigh Township Police
Northern Valley EMS
Lehigh Township Fire Department
Diamond Fire Company
Northampton Regional EMS
Northampton School District

Quality

Reliability

Integrity

DISTRICT	COUNTY	ROUTE	SECTION	SHEET
5-0	NORTHAMPTON	4020	000	2 OF 2
REV. NO.	REVISIONS TRAIL			
DATE	BY	APPD.		

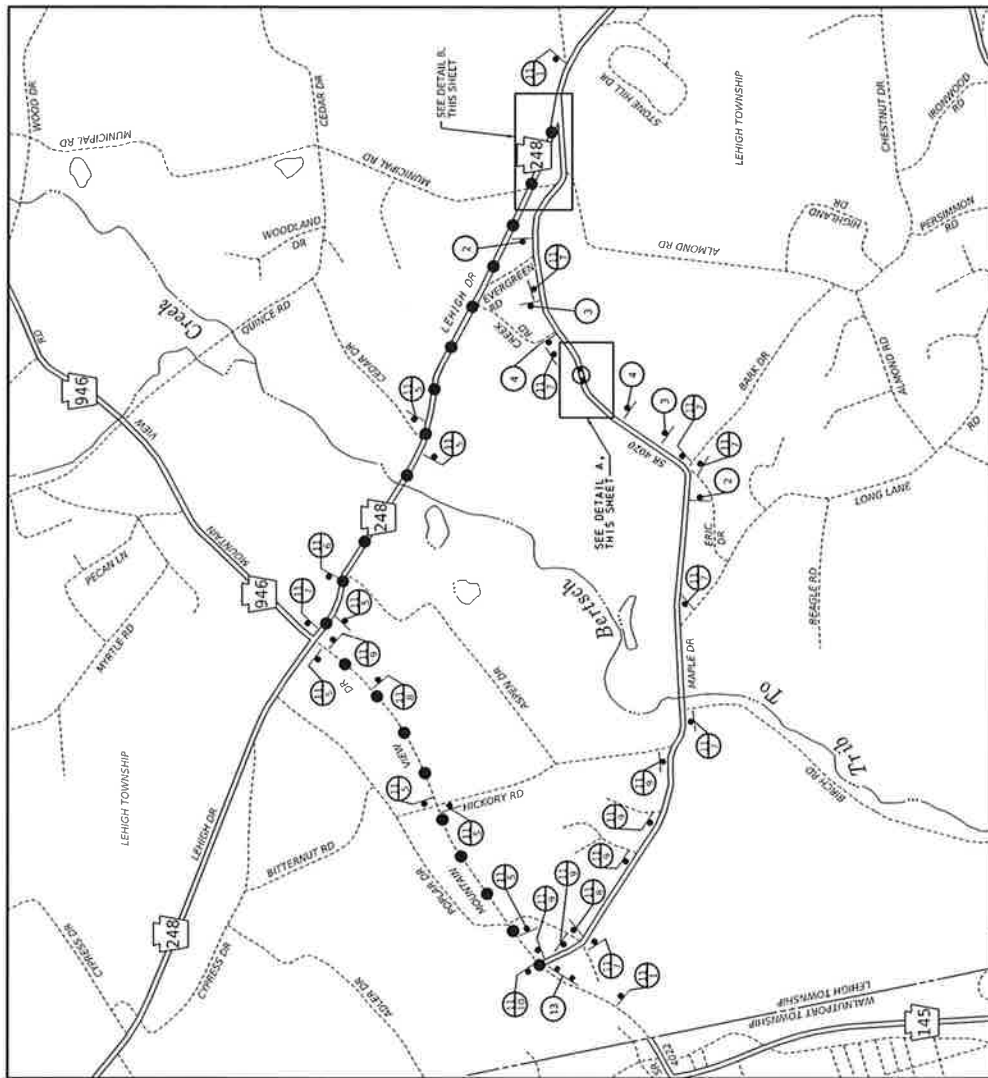

DETOUR MAP
SCALE
0 750 1500 FEET

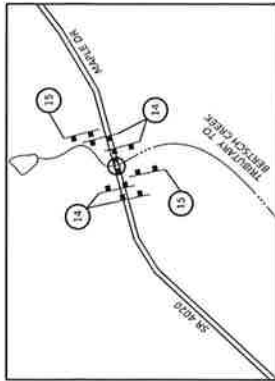

DETAIL A
NOT TO SCALE

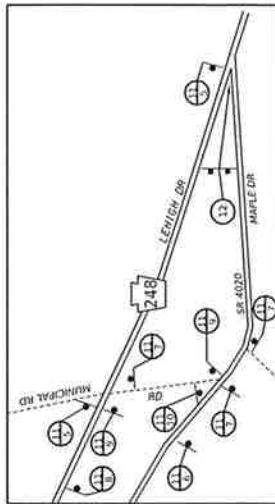

DETAIL B
NOT TO SCALE

- LEGEND**
- PROJECT LOCATION
 - SIGN REFERENCE NUMBER
 - TEMPORARY PORTABLE SIGN POST
 - TYPE III BARRICADE
 - STATE ROAD
 - TOWNSHIP ROAD
 - DETOUR (LENGTH = 2.3 MI)
 - TOWNSHIP BOUNDARY
 - STREAM



TRAFFIC CONTROL PLAN